

Filter Adapters

Non-filter applications can easily be upgraded to EMI/Transient protection without modification to the system with Smiths Interconnect In-Line Filter Adapters. Filter adapters provide the system designer great flexibility in situations where the filtering or system requirements are subject to change. The adapters are designed to be installed between the existing plug and receptacle without having to re-wire or disassemble the system. Both in-line cable and bulkhead/panel mount versions are available.

Adapters can be built for any connector series including: MIL-DTL-38999, MIL-C-26482, MIL-DTL-83723, MIL-DTL-24308, MIL-DTL-83513, ARINC 404, and ARINC 600. Consult the factory for more information.



**MIL-DTL-38999
Series I Adapter**

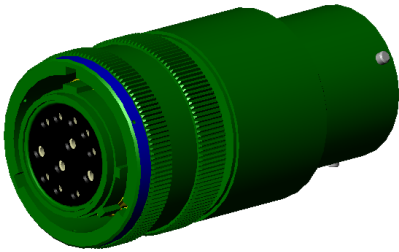

**MIL-DTL-38999
Series III Adapter**

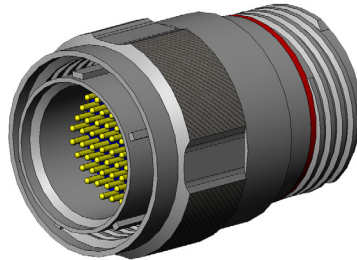

**MIL-DTL-24308
D-Subminiature Adapter**

