

# SPECIFICATION CONTROL DRAWING

PART IDENTIFIER: R060-125A -X-X  
 TOLERANCE VALUE

DESCRIPTION: ROD RESISTOR, ALUMINA  
 ASSEMBLY DWG: R060-125A

**SPECIFICATIONS:**

- ELECTRICAL: RESISTANCE RANGE: 10 OHMS TO 50 OHMS\*\*  
 TOLERANCE: 1%, 2% OR 5%  
 POWER HANDLING: 0.12 WATT (-55° C - 80° C, DERATE LINEARLY TO 0 WATTS @ 150° C)  
 PER MIL-STD-454, REQUIREMENT 9
- MECHANICAL WORKMANSHIP: PER MIL-STD-454, REQUIREMENT 9
- ENVIRONMENTAL: TEMPERATURE RANGE: -55° C TO +150° C
- MATERIAL: SUBSTRATE: ALUMINA 96% MIL-I-10  
 TERMINAL: SOLDER COATED NICKEL  
 RESISTIVE FILM: NICHROME

UNIT MARKING: NONE

**QUALITY ASSURANCE:**

- SAMPLE INSPECT PER ANSI/ASQC Z1.4 GENERAL INSPECTION, LEVEL II, AQL = 1.0
- VISUAL AND MECHANICAL EXAMINATION FOR CONFORMANCE TO CONTROL DRAWING REQUIREMENTS
- 100% DCR TESTING

PACKAGING: STANDARD PACKING PER 755W002

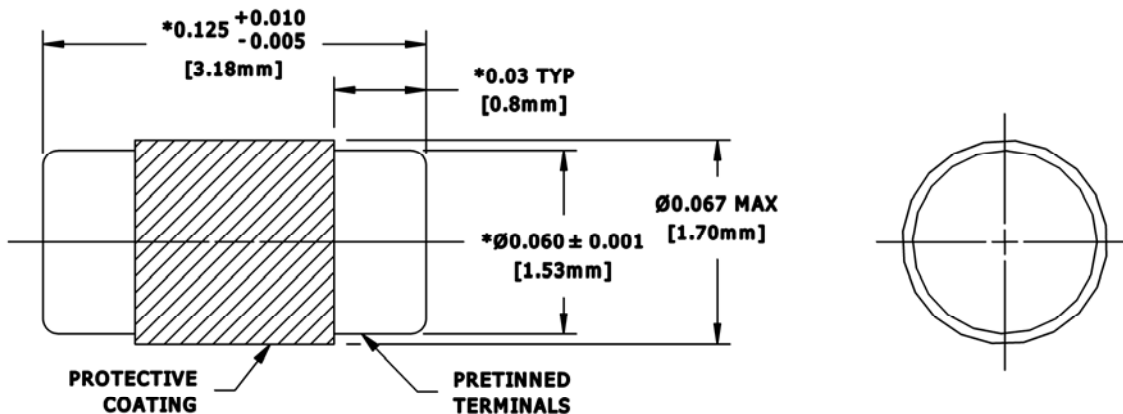

**NOTES:**

- \*DIMENSIONS APPLY BEFORE SOLDER. ALLOW 0.020 MAX FOR ALL PRETINNED SURFACES.
- \*\*CONSULT FOR VALUES OUTSIDE OF THIS RANGE

<p>8851 SW OLD KANSAS AVE STUART, FL 34997</p> <p>PHONE NO. (772) 286-9300 FAX NO. (772) 283-5286</p>	<b>UNLESS OTHERWISE SPECIFIED</b>		THESE DRAWINGS AND SPECIFICATIONS ARE THE PROPERTIES OF EMC TECHNOLOGY AND FLORIDA RF LABS AND SHALL NOT BE DUPLICATED OR USED AS BASIS FOR THE MANUFACTURE OR SALES OF PARTS OR DEVICES WITHOUT PERMISSION.		
	<p><b>NOTES</b></p> <p>1. DO NOT SCALE DRAWING 2. DIMENSIONS ARE IN INCHES</p> <p>METRIC EQUIVALENTS GIVIN IN [mm] FOR REFERENCE INFORMATION ONLY</p>	<p><b>TOLERANCES</b></p> <p>X.XX ± 0.01 X.XXX ± 0.002 X.XXXX ± 0.0005</p> <p>FRACTIONS ± 1/16 ANGLES ± 5°</p>	<p>PART ID REF</p> <p>R060-125A</p>	<p>DRAWING NUMBER</p> <p>R060-125A-SCD</p>	<p>REV</p> <p>-</p>