

PART ID REF
HR03XXX

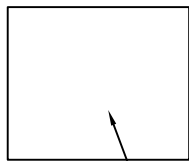

MARKING THIS SURFACE

0-10dB

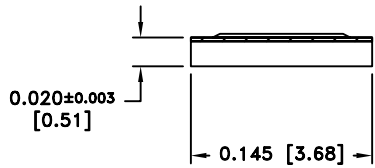
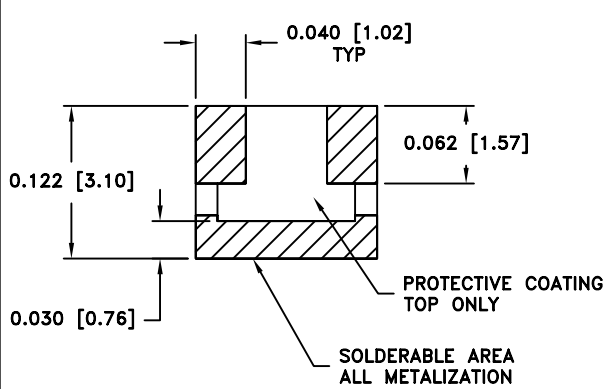
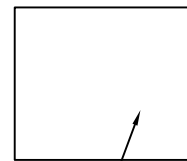
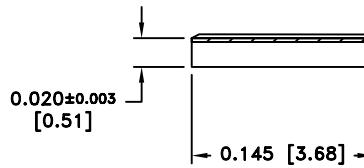
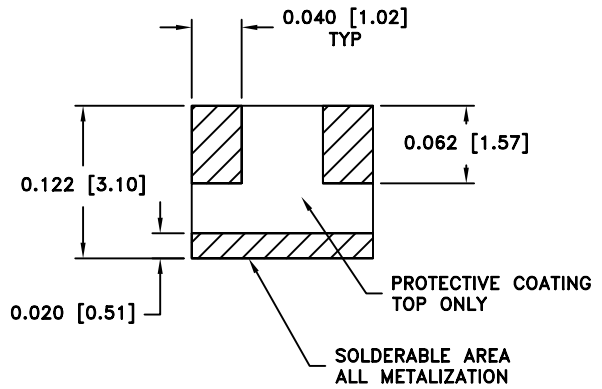

MARKING THIS SURFACE

11-20dB

MECHANICAL SPECIFICATIONS:

SUBSTRATE:
MATERIAL - ALUMINA 96%, MIL-I-10.
TERMINAL:
MATERIAL - THICK FILM, NICKEL BARRIER,
SOLDER COATED.
RESISTIVE ELEMENT:
MATERIAL - THIN FILM, TANTALUM NITRIDE.

METRIC EQUIVALENTS GIVEN IN [mm]
FOR REFERENCE INFORMATION ONLY

POWER RATING AND DERATING

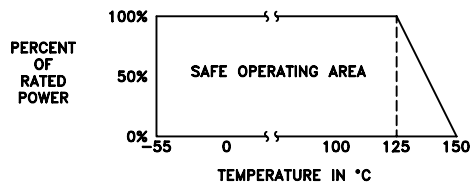

 8851 SW OLD KANSAS AVE STUART, FL 34997 PHONE NO. (772)286-9300 FAX NO. (772)283-5286	UNLESS OTHERWISE SPECIFIED DIMENSIONS ARE IN INCHES TOLERANCES FRACT --- -- ANG --- -- XX --- -- XXX ±0.005 XXXX --- --	THESE DRAWINGS AND SPECIFICATIONS ARE THE PROPERTY OF EMC TECHNOLOGY INC AND SHALL NOT BE DUPLICATED OR USED AS BASIS FOR THE MANUFACTURE OR SALE OF PARTS OR DEVICES WITHOUT PERMISSION.					
	CAGE CODE 24602	SCALE 10:1	DRAWN BY JG 12/8/04	CHECKED BY	APPROVED BY DAR 12/8/04		
	REV B	CHANGE NOTICE EN 09-E1001		DRAWING NO 1009875000		SHEET 2 OF 2	