

SMT Series

Surface Mount Terminations

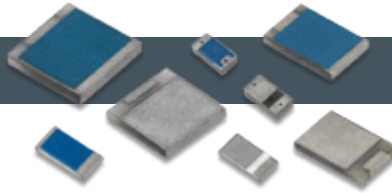

We offer a wide selection of SMT chip terminations handling input power levels up to 250W and covering frequency ranges up to 4 GHz. Using EMC's patented asymmetrical wrap geometry, the thermal dissipation of the surface mount termination is improved by increasing the solderable grounding area. This eliminates the need for bolt down heat sinks and tabs, thereby reducing assembly costs.

Specifications

Impedance	50 Ohms
Frequency Range	DC to 4 GHz
Power Rating	100% @ 100 °C
Derates to	0% @ 150 °C
Operating Temperature	-55 °C to 150 °C
Resistive Material	Thick Film
Terminal Material	Thick Film, Nickel Barrier, Solder or no lead Silver Plated Finish

SMT

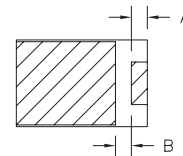
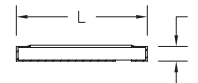
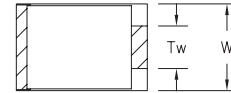

For A, B and Tw dimensions see data sheet on website.

Power Rating and Derating

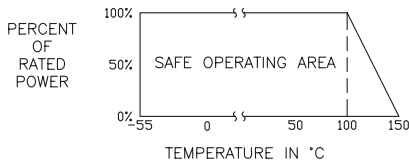

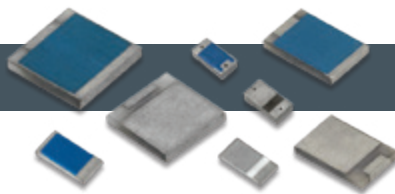

Part Numbering Code

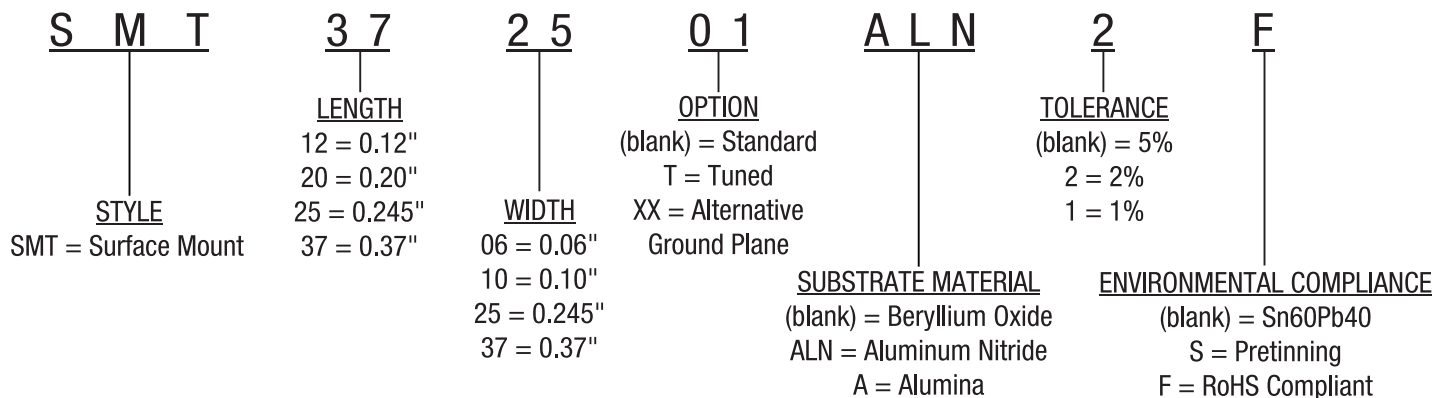

Power Watt	Frequency GHz	VSWR Max:1	Substrate	L		W		T		Part Series #
				mm	[inches]	mm	[inches]	mm	[inches]	
10	2.0	1.25	AlN	3.04	[0.120]	1.52	[0.060]	0.68	[0.027]	SMT1206 *ALN
10	3.0	1.25	Alumina	5.08	[0.200]	2.54	[0.100]	0.64	[0.025]	SMT2010*A
15	3.0	1.25	Alumina	6.35	[0.250]	6.35	[0.250]	1.04	[0.041]	SMT2525*A
20	4.0	1.20	AlN	5.08	[0.200]	2.54	[0.100]	0.64	[0.025]	SMT2010TALN
20	2.0	1.25	AlN	5.08	[0.200]	2.54	[0.100]	1.04	[0.041]	SMT2010*ALN
20	3.0	1.25	Alumina	9.40	[0.370]	6.35	[0.250]	0.64	[0.025]	SMT3725*A
25	3.0	1.25	Alumina	9.53	[0.375]	9.52	[0.375]	0.64	[0.025]	SMT3737*A
30	2.0	1.25	BeO	5.08	[0.200]	2.54	[0.100]	1.04	[0.041]	SMT2010
60	2.0	1.25	AlN	6.35	[0.250]	6.35	[0.250]	1.04	[0.041]	SMT2525*ALN
60	2.7	1.15	AlN	6.35	[0.250]	6.35	[0.250]	1.04	[0.041]	SMT2525TALNF
75	2.0	1.25	BeO	6.35	[0.250]	6.35	[0.250]	1.04	[0.041]	SMT2525
80	2.7	1.15	AlN	9.53	[0.375]	6.35	[0.250]	1.04	[0.041]	SMT3725TALN
80	2.0	1.25	AlN	9.53	[0.375]	6.35	[0.250]	1.04	[0.041]	SMT3725*ALN
100	2.7	1.15	AlN	9.40	[0.372]	9.40	[0.372]	1.30	[0.051]	SMT3737TALN
100	2.0	1.25	AlN	9.40	[0.372]	9.40	[0.372]	1.30	[0.051]	SMT3737*ALN
125	2.0	1.25	BeO	9.53	[0.375]	6.35	[0.250]	1.04	[0.041]	SMT3725
150	2.0	1.25	BeO	9.40	[0.372]	9.40	[0.372]	1.30	[0.051]	SMT3737
150	4.0	1.20	AlN	6.35	[0.250]	6.35	[0.250]	1.04	[0.041]	SMT252503ALN2F
200	2.7	1.20	AlN	9.40	[0.370]	6.22	[0.245]	1.04	[0.041]	SMT372503ALN2F

"F" suffix (RoHS) is not available with Pretinning ("S" suffix)

*** Is a place holder. See part number configurations to complete the part number