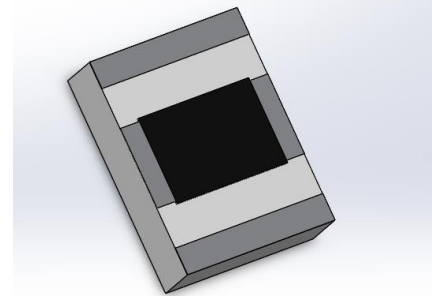

RESISTOR CHIP OUTRIGGER 12.5 WATTS**DATASHEET PART SERIES: CRHA1216XXXXF**Sheet 1 of 2
Doc# CRHA1216XXXXF-1016145ECO-085210
Revision A**ORDERING INFORMATION****Part Identifier: CRHA1216XXX XF**

X = Tolerance (%).

XXX = Resistance Value (Ω).**SPECIFICATIONS****1.0 ELECTRICAL**

Frequency Range:	DC –20GHz.
Resistance Range:	10 - 500 Ω .
Resistance Tolerance:	$\pm 2\%$ or $\pm 5\%$.
Temperature Coefficient of Resistance:	± 200 PPM/ $^{\circ}\text{C}$ Max.
Input Power CW:	12.5 Watts .
Peak Power:	125 Watts, 10 μs pulse width, 1% duty cycle.

2.0 ENVIRONMENTAL

Operating Temperature:	-55 $^{\circ}\text{C}$ to +150 $^{\circ}\text{C}$.
Non-operating Temperature:	-65 $^{\circ}\text{C}$ to +150 $^{\circ}\text{C}$.

3.0 MARKING

Unit Marking:	None.
---------------	-------

4.0 QUALITY ASSURANCE

Visual and Mechanical Inspection:	Per 824W107.
DC Resistance Check:	100% DC Resistance Check.
Data Retention:	Standard.

5.0 PACKAGING

Standard Packaging:	Tape and Reel.
---------------------	----------------

6.0 MECHANICAL

Substrate Material:	ALN.
Resistive Film:	Thick Film.
Terminal Material:	Thick Film, Silver/Nickel Plating.
Metric Dimensions:	Provided for reference only.

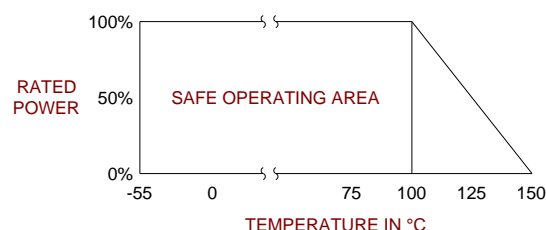

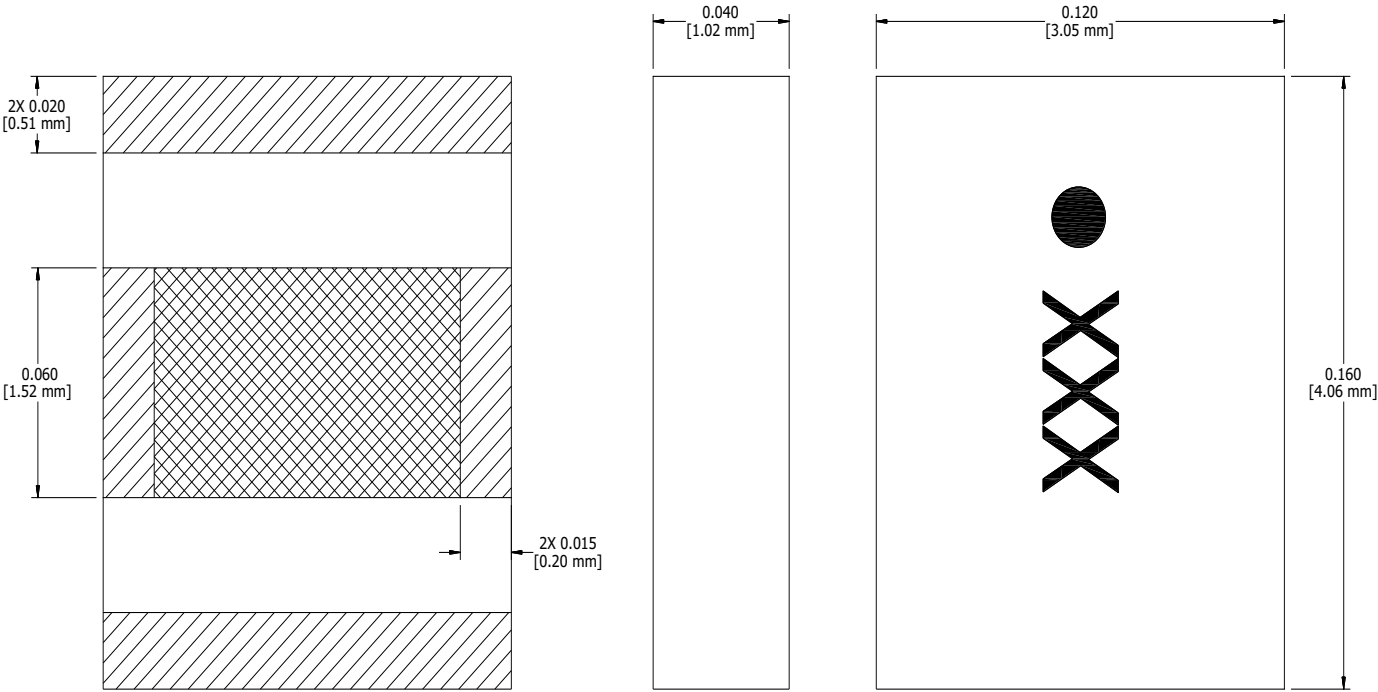

Note: Specifications are subject to change.

Unless Otherwise Specified: TOLERANCE: X.XX = ± 0.01 X.XXX = ± 0.002.

7.0 SUGGESTED MOUNTING FOOTPRINT

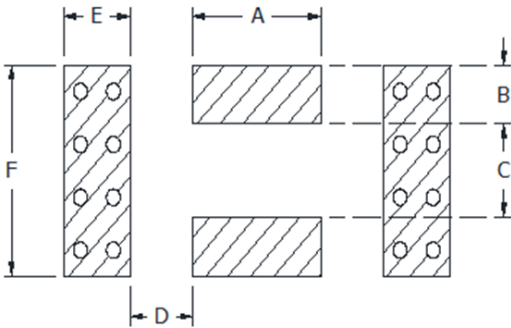

Part Number	Inches						mm					
	A	B	C	D	E	F	A	B	C	D	E	F
CRHA1216XXX5F	0.065	0.017	0.090	0.030	0.025	0.125	1.651	0.43	2.29	0.76	0.64	3.18