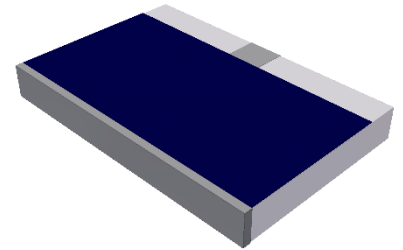

**ORDERING INFORMATION****PART IDENTIFIER: 82-3031****SPECIFICATIONS****1. ELECTRICAL:**

Nominal Impedance:	50 $\Omega$ .
Frequency Range:	DC - 2.0 GHz.
VSWR:	1.10:1 Max.
Input Power CW:	150 Watts @ 85°C heat sink, derated linearly to zero power and 150°C.
Peak Power:	1500 Watts (based on 10 $\mu$ s pulse width and 1% duty cycle).
DC Resistance:	50 $\Omega$ $\pm$ 2 %.

**2. ENVIRONMENTAL:**

Operating Temperature:	-55°C to +150°C.
Non-operating Temperature:	-65°C to +150°C.
Temperature Coefficient:	+/-200 PPM / °C max.

**3. MARKING:**

Unit Marking:	No Marking.
---------------	-------------

**4. QUALITY ASSURANCE:**

Visual and Mechanical Inspection:	Per 824W107.
DC Resistance Check:	100% DC Resistance Check.
Data Retention:	Standard.

**5. PACKAGING:**

Standard Packaging:	Tape and Reel.
---------------------	----------------

**6. MECHANICAL:**

Substrate Material:	Beryllium Oxide.
Resistive Film:	Nichrome.
Terminal Material:	Tin/Lead.
Metric Dimensions:	Provided for reference only.

TERMINATION CHIP 150 WATT

DATASHEET PART SERIES: 82-3031

Sheet 2 of 2  
Doc# 82-3031

ECO-083989  
Revision -

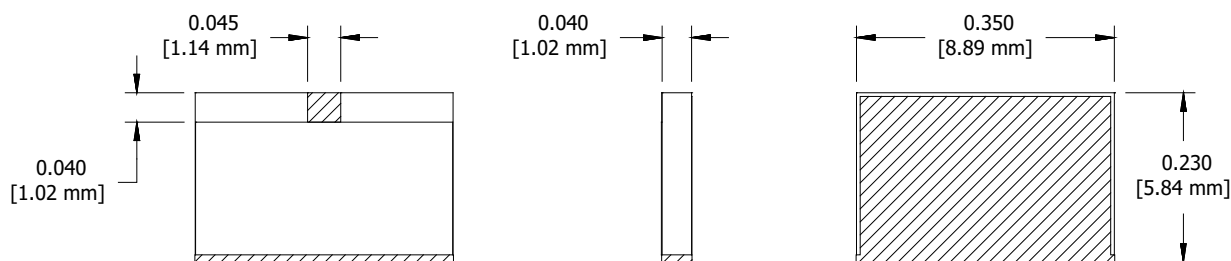
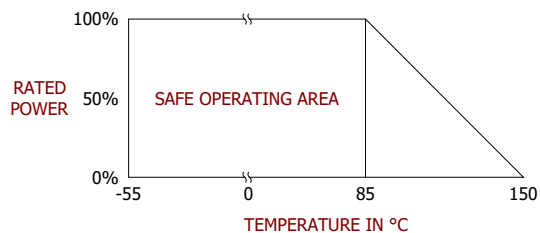

Unless Otherwise Specified: TOLERANCE: X.XX = ± 0.02 X.XXX = ± 0.010.