

ORDERING INFORMATION

PART IDENTIFIER:

CT0404ALN1WB1

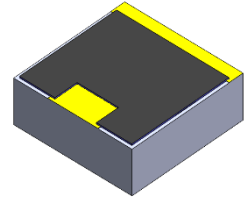
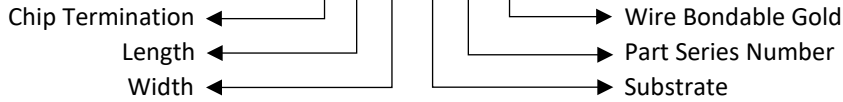

ASSEMBLY DWG: 1000714

SPECIFICATIONS

1.0 ELECTRICAL

Nominal Impedance:	50 Ω ± 10%
Frequency Range:	DC – 42.5 GHz.
Input Power CW:	5 W.

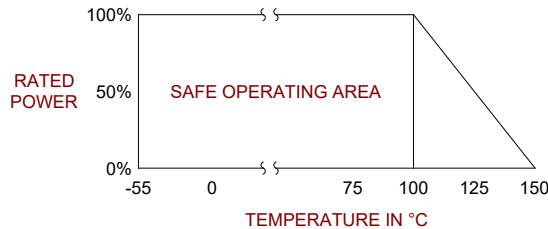

Peak Power:	50 W (1μs pulse width/1% duty cycle).
*VSWR	*1.25:1 Typical; 1.40:1 Max.
*Note: When properly installed in a matched 50 Ω system per Smiths Interconnect recommended mounting criteria.	

2.0 ENVIRONMENTAL

Operating Temperature:	-55°C to +150°C.
Non-operating Temperature:	-65°C to +150°C.
Temperature Coefficient:	± 200 PPM / °C Max

3.0 MARKING

Unit Marking:	None.
---------------	-------

4.0 QUALITY ASSURANCE

- Sample Inspect Per ANSI/ASQC Z1.4 General Inspection, Level II, AQL=1.0.
- Visual and Mechanical Examination for Conformance to Outline Drawing Requirements.
- Measure DC Resistance.
- Data Retention – Standard.

5.0 PACKAGING

Standard Packaging:	Waffle or Tape and Reel.
---------------------	--------------------------

6.0 MECHANICAL

Substrate Material:	Aluminum Nitride.
Terminal Material:	Gold Over Palladium.
Ground Plane:	Solderable.
Resistive Element:	Thin Film, Tantalum Nitride.
Metric Dimensions:	Provided for Reference Only.

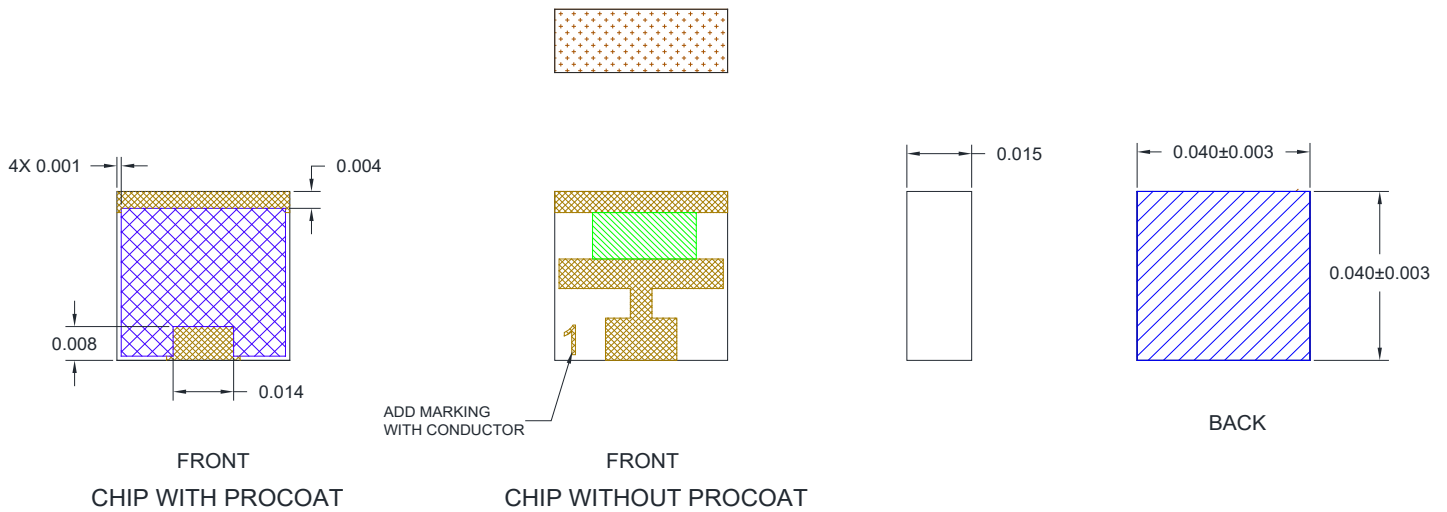

Unless Otherwise Specified: TOLERANCE: X.XXX = ± 0.001.