

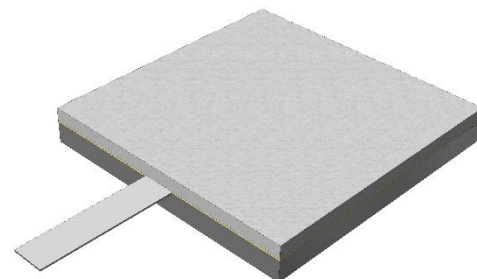

## ORDERING INFORMATION

**PART IDENTIFIER: 82A3209TCF**



## SPECIFICATIONS

### 1. ELECTRICAL:

Nominal Impedance:	50 ohms
Frequency Range:	DC - 2.5 GHz
VSWR:	1.25 Max @ DC – 2.0 GHz 1.50 Max @ 2.0 – 2.5 GHz
Input Power CW:	500
Peak Power:	5000
DC Resistance:	50 Ω ± 5%

### 2. ENVIRONMENTAL:

Operating Temperature:	-55°C to +150°C
Non-operating Temperature:	-65°C to +150°C
Temperature Coefficient:	+/-200 PPM / °C max

### 3. MARKING:

Unit Marking:	EMC Logo and Part Number
---------------	--------------------------

### 4. QUALITY ASSURANCE:

Visual and Mechanical Inspection:	Per 824W107
DC Resistance Check:	100% DC Resistance Check
Data Retention:	Standard

### 5. PACKAGING:

Standard Packaging:	Tray
---------------------	------

### 6. MECHANICAL:

Substrate Material:	Beryllium Oxide
Resistive Film:	Thin Film
Cover Material:	Alumina
Tab Material:	Beryllium Copper
Tab Finish:	Silver



Metric Dimensions:

Provided for reference only

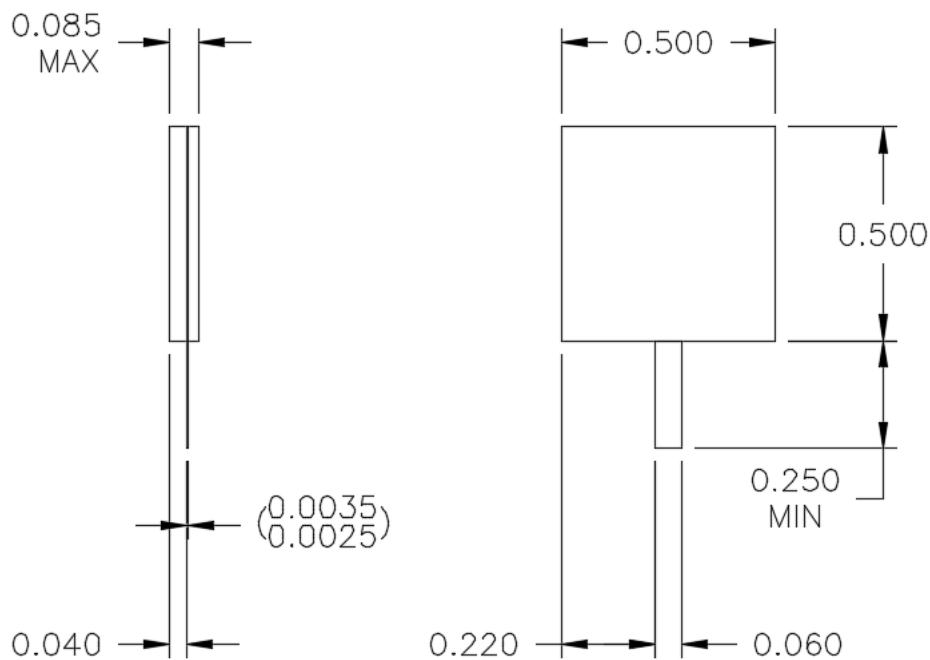
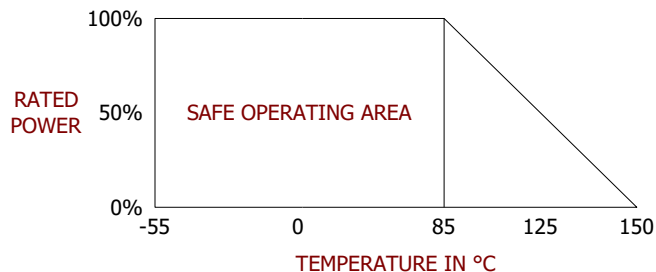

Unless Otherwise Specified: TOLERANCE: X.XX = ± 0.01 X.XXX = ± 0.005