

TERMINATION, HIGH POWER, 1000 WATT



DATA SHEET

PART SERIES: 32A5001F

SHEET 1 OF 2
Dwg 1016255ECO-065938
Revision A

FEATURES

Spring Mount
Tab Launch
Increase Power Handling
Optimized RF Performance

APPLICATIONS

Power Amplifiers
Isolators
Radar
Medical MRI

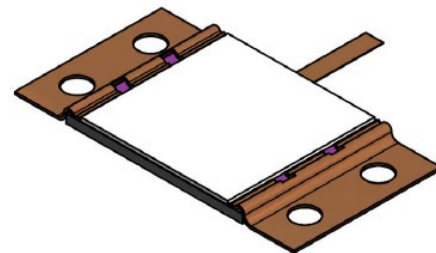

GENERAL DESCRIPTION

Smiths Interconnect offers a new innovative solution to improve power handling in resistive devices. The High Power Termination series of products enhances power handling capability and RF performance over traditional flange mount devices. This solution eliminates CTE mismatch concerns seen in flange mount devices and significantly reduces weight. The High Power Termination series of products is offered in an easy to implement package offered in the same footprints as traditional flange mount terminations.

ORDERING INFORMATION

Part Identifier: 32A5001F

SPECIFICATIONS

1.0 ELECTRICAL

Nominal Impedance:	50 Ω
Frequency Range:	DC - 900 MHz
VSWR:	1.20:1
Input Power CW:	1000 Watt (See AN0027)
DC Resistance:	50 Ω \pm 5% 50 Ω \pm 5%

2.0 ENVIRONMENTAL

Operating Temperature:	-55°C to +150°C
Non-operating Temperature:	-65°C to +150°C
Temperature Coefficient:	+/-200 PPM / °C max

3.0 MARKING

Unit Marking:	Logo and Part Number, legibility and permanency per MIL-STD-130
---------------	---

4.0 QUALITY ASSURANCE

Visual and Mechanical Inspection:	Per 824W107
DC Resistance Check:	100% DC Resistance Check
Data Retention:	Standard

5.0 PACKAGING

Standard Packaging:	Tray Packaging
---------------------	----------------

TERMINATION, HIGH POWER, 1000 WATT



DATA SHEET

PART SERIES: 32A5001F

SHEET 2 OF 2
Dwg 1016255

ECO-065938
Revision A

6.0 MECHANICAL

Substrate Material:	Beryllium Oxide
Resistive Film:	Thin Film
Cover Material:	Alumina
Tab Material:	Beryllium Copper as per ASTM B194
Tab Finish:	Silver Plated
Mounting Clips Material:	Beryllium Copper
Mounting Clips Finish:	Silver Plated
Metric Dimensions:	Provided for reference only

Note: Mounting clips are supplied separate. See AN0027 Note for installation instructions.

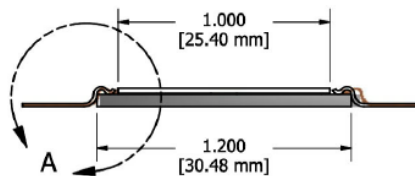
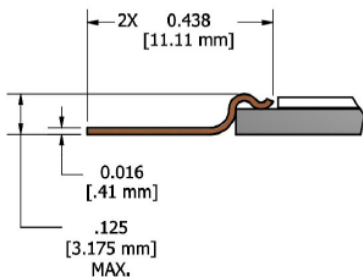
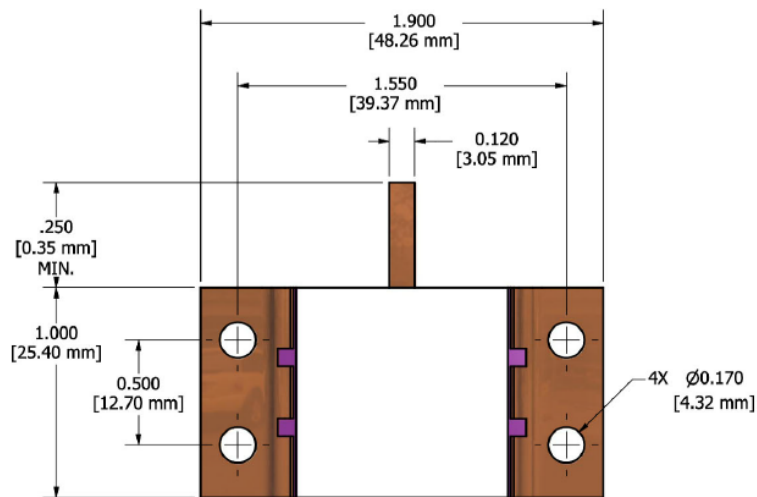
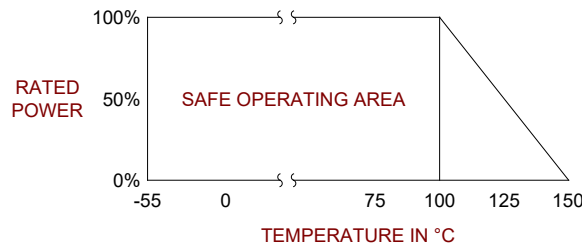

Unless Otherwise Specified: TOLERANCE: X.XX = ± 0.01 X.XXX = ± 0.010